

# THREAD/LEAD SCREW PITCH DIAMETER SNAP GAGES

BALL TIP DIAMETER  
CAN BE CUSTOMIZED

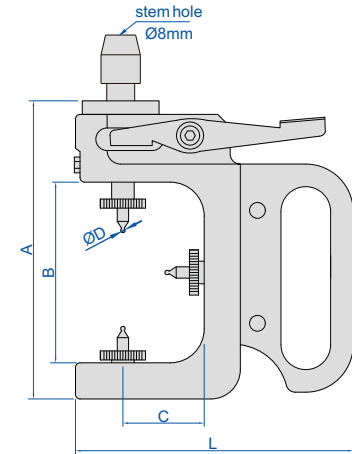

2165-40

- Measure the pitch diameter of lead screw and external thread
- Ball tip diameter can be customized according to workpieces.  
Diameter of trapezoidal screw or external thread ball tips:  
 $\text{ØD} = 0.5 \times \text{pitch } P / \cos(\text{thread angle } \alpha/2)$ .  
Ball tips diameter ØD of ball screw is corresponding steel ball specification
- Probe retracting range: 3mm, measuring force: 20N
- Repeatability: 2µm
- Optional accessory: 0.001mm digital/dial indicators

(mm)

Code	Range	Accuracy	A	B	C	L
2165-20	3-20mm	±5µm	116	60	27	113
2165-40	20-40mm	±5µm	132	80	37	123
2165-60	40-60mm	±5µm	152	138	46	100
2165-80	60-80mm	±5µm	172	156	59	121
2165-100	80-100mm	±5µm	192	170	68	140